

TO-THFN-74	TO-THCN-74	TO-THN-74
TO-THFN-30F	TO-THCN-30F	TO-THN-30F
TO-THFN-30K	TO-THCN-30K	TO-THN-30K
TO-THFN-30X	TO-THCN-30X	TO-THN-30X
TO-THFN-30XF	TO-THCN-30XF	TO-THN-30XF
TO-THFN-30XK	TO-THCN-30XK	TO-THN-30XK

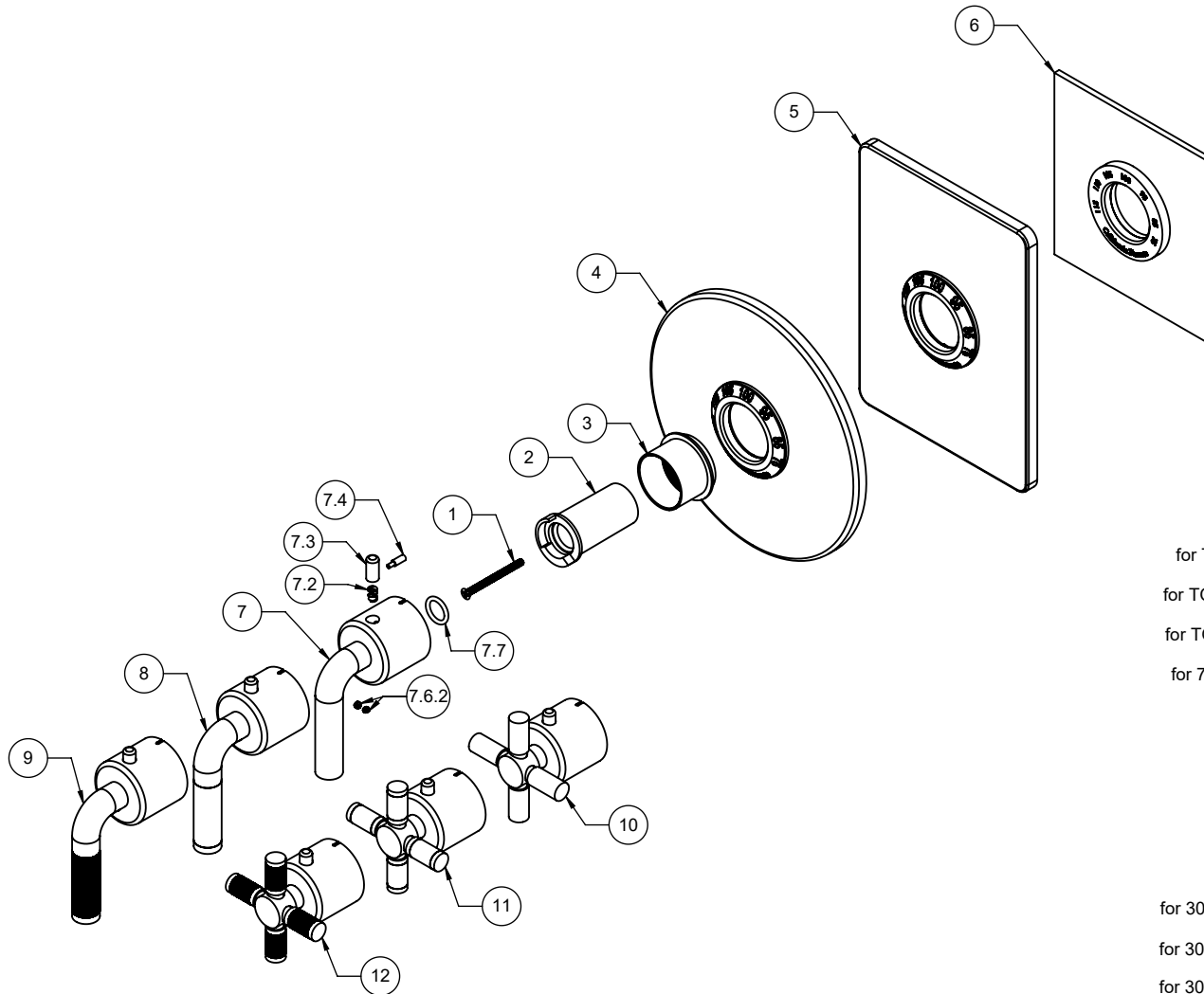

To order spare parts add and/or replace as stated below:

SPD- prefix added to part number(s)
-ZZ replaced with finish code (see finish table)
-WW replaced with **-90** (light finish) or **-96** (dark finish)

Ex: **SPD-7-100278-PC** or **SPD-86030-96**

ITEM	PART NO.	DESCRIPTION	QTY.	
1	86255-90	SCREW M4 X 0.7 X 50MM PH FLT HD SS	1	
2	10092-81	STOP, THERM TEMP, SHORT	1	
3	10090-ZZ	SLEEVE, THERMO MOUNTING	1	
for TO-THN	4	7-100040-ZZ	ASM, SHWRPLATE, CONT RD, THERM	1
for TO-THCN	5	7-100046-ZZ	ASM, SHWRPLATE, CONT SQ, THERM	1
for TO-THFN	6	7-100238-ZZ	ASM, SHOWERPLATE, CONT SQ, THERM	1
for 74 series	7	TH-H-74-ZZ	THERM HANDLE KIT (incl. 7.2, 7.3, 7.4, 7.6.2, 7.7)	1
	7.2	10098-99	SPRING, Ø.24 X .312 LG, 1.4 LB/IN	1
	7.3	10093-81	BUTTON, BLACK THERM	1
	7.4	10062-98	PIN, THERMO BONNET	1
	7.6.2	86030-WW	SETSCREW 8-32 X 1/8 SCKT HD CUP PT SS	2
	7.7	87222-80	O-RING Ø13.94 X 2.62 (-113) EPDM A70 (NSF61-12 & WRAS)	1
for 30F series	8	TH-H-30F-ZZ	THERM HANDLE KIT (incl. 7.2, 7.3, 7.4, 7.6.2, 7.7)	1
for 30K series	9	TH-H-30K-ZZ	THERM HANDLE KIT (incl. 7.2, 7.3, 7.4, 7.6.2, 7.7)	1
for 30X series	10	TH-H-30X-ZZ	THERM HANDLE KIT (incl. 7.2, 7.3, 7.4, 7.6.2, 7.7)	1
for 30XF series	11	TH-H-30XF-ZZ	THERM HANDLE KIT (incl. 7.2, 7.3, 7.4, 7.6.2, 7.7)	1
for 30XK series	12	TH-H-30XK-ZZ	THERM HANDLE KIT (incl. 7.2, 7.3, 7.4, 7.6.2, 7.7)	1
for ITEM 7.6.2	13	882042-99	KEY, ALLEN, 5/64", BLACK	1