

TO-THC1L-80WB
 TO-THC1L-80WR
 TO-THF1L-80
 TO-THF1L-80W
 TO-THF1L-80WB
 TO-THF1L-80WR

TO-TH1L-80
 TO-TH1L-80W
 TO-TH1L-80WB
 TO-TH1L-80WR
 TO-THC1L-80
 TO-THC1L-80W

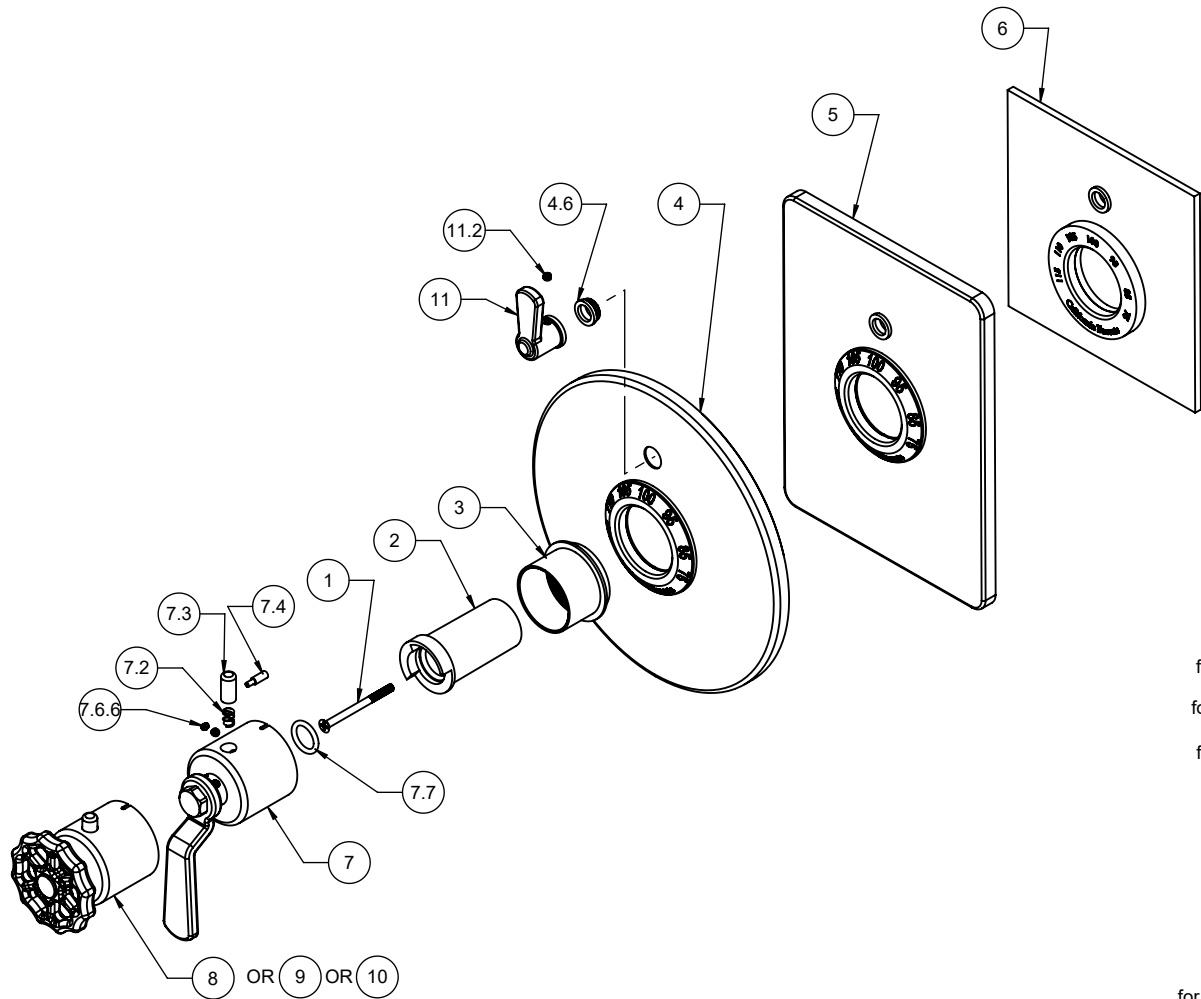

To order spare parts add and/or replace as stated below:

SPD- prefix added to part number(s)

-ZZ replaced with finish code (see finish table)

-WW replaced with -90 (light finish) or -96 (dark finish)

Ex: **SPD-7-100463-PC** or **SPD-86030-96**

ITEM	PART NO	DESCRIPTION	QTY.
1	86059-90	SCREW M4 X 0.7 X 6MM PH FLT HD SS	1
2	10092-81	STOP, THERM TEMP, SHORT	1
3	10090-ZZ	SLEEVE, THERMO MOUNTING	1
4	7-100041-ZZ	ASM, SHWRPLATE, CONT RD, THERM W/1VC <i>(incl. 4.6)</i>	1
4.6	223467-99	NYLON BUSHING FOR PBS FACEPLATE	1
5	7-100047-ZZ	ASM, SHOWERPLATE, CONT SQ, THERM W/1VC <i>(incl. 4.6)</i>	1
6	7-100239-ZZ	ASM, SHWRPLATE, CONT FLAT, THERM W/1 VC <i>(incl. 4.6)</i>	1
7	TH-H-80-ZZ	THERM HANDLE KIT <i>(incl. 7.2, 7.3, 7.4, 7.6.6, 7.7)</i>	1
7.2	10098-99	SPRING, Ø.24 X .312 LG, 1.4 LB/IN	1
7.3	10093-81	BUTTON, BLACK THERM	1
7.4	10062-98	PIN, THERMO BONNET	1
7.6.6	86170-WW	SETScrew 8-32 X 1/8" SCKT CONE PT SS	2
7.7	87222-80	O-RING Ø13.94 X 2.62 (-113) EPDM A70 (NSF61-12 & WRAS)	1
8	TH-H-80W-ZZ	THERM HANDLE KIT <i>(incl. 7.2, 7.3, 7.4, 7.6.6)</i>	1
9	TH-H-80WB-ZZ	THERM HANDLE KIT <i>(incl. 7.2, 7.3, 7.4, 7.6.6)</i>	1
10	TH-H-80WR-ZZ	THERM HANDLE KIT <i>(incl. 7.2, 7.3, 7.4, 7.6.6)</i>	1
11	7-100548-ZZ	ASM, THERM VC - BALL LEVER <i>(incl. 11.2)</i>	1
11.2	86030-WW	SETScrew 8-32 X 1/8 SCKT HD CUP PT SS	1
12	882042-99	KEY, ALLEN, 5/64", BLACK	1

for TO-TH1L

for TO-THC1L

for TO-THF1L

for 80 Series

for 80W Series

for 80WB Series

for 80WR Series

for ITEM 7.6.6 & 11.2