

TO-PBL-80
 TO-PBL-80W
 TO-PBL-80WB
 TO-PBL-80WR
 TO-PB2L-80
 TO-PB2L-80W
 TO-PB2L-80WB
 TO-PB2L-80WR

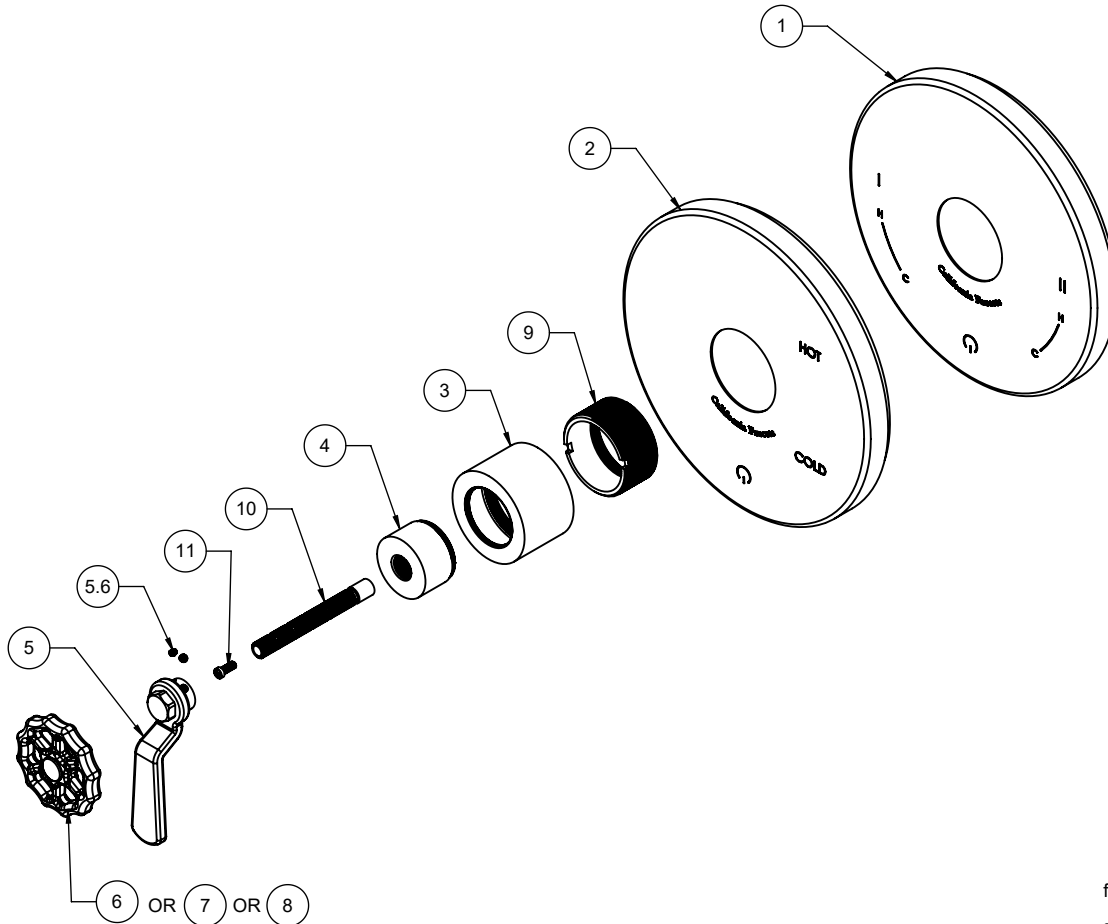

To order spare parts add and/or replace as stated below:

SPD- prefix added to part number(s)
-ZZ replaced with finish code (see finish table)
-WW replaced with **-90** (light finish) or **-96** (dark finish)

Ex: **SPD-7-100463-PC** or **SPD-86030-96**

	ITEM	PART NO	DESCRIPTION	QTY.
for TO-PB2L	1	7-100547-ZZ	ASM, CONT PB2 PLATE & GASKET	1
for TO-PBL	2	7-100106-ZZ	ASM, CONT PB PLATE & GASKET	1
	3	10294-ZZ	ESCUTCHEON, CONT, PB G2	1
	4	571380-ZZ	ESCUTCHEON, 57, SERIES	1
for 80 Series	5	7-100536-ZZ	ASM, BALL LEVER HDL (incl. 5.6)	1
	5.6	86170-WW	SETSCREW 8-32 X 1/8" SCKT CONE PT SS	2
for 80W Series	6	7-100465-ZZ	ASM, SPOKED WHEEL (incl. 5.6)	1
for 80WB Series	7	7-100465B-ZZ	ASM, SPOKED WHEEL - BLACK (incl. 5.6)	1
for 80WR Series	8	7-100465R-ZZ	ASM, SPOKED WHEEL - RED (incl. 5.6)	1
	9	10292-98	BUSHING, PB G2	1
	10	880137-98	BROACH EXTENSION 3-1/4"(L) X 16T(M) X 20T(F)	1
	11	86078-90	SCREW, M4 X 0.7 X 10MM, w/Ø5.80 PHL PH HD SS	1
for ITEM 5.6	12	882042-99	KEY, ALLEN, 5/64", BLACK	1