

TO-PBL-53	TO-PBL-52
TO-PBL-53F	TO-PBL-52F
TO-PBL-53K	TO-PBL-52K
TO-PB2L-53	TO-PB2L-52
TO-PB2L-53F	TO-PB2L-52F
TO-PB2L-53K	TO-PB2L-52K

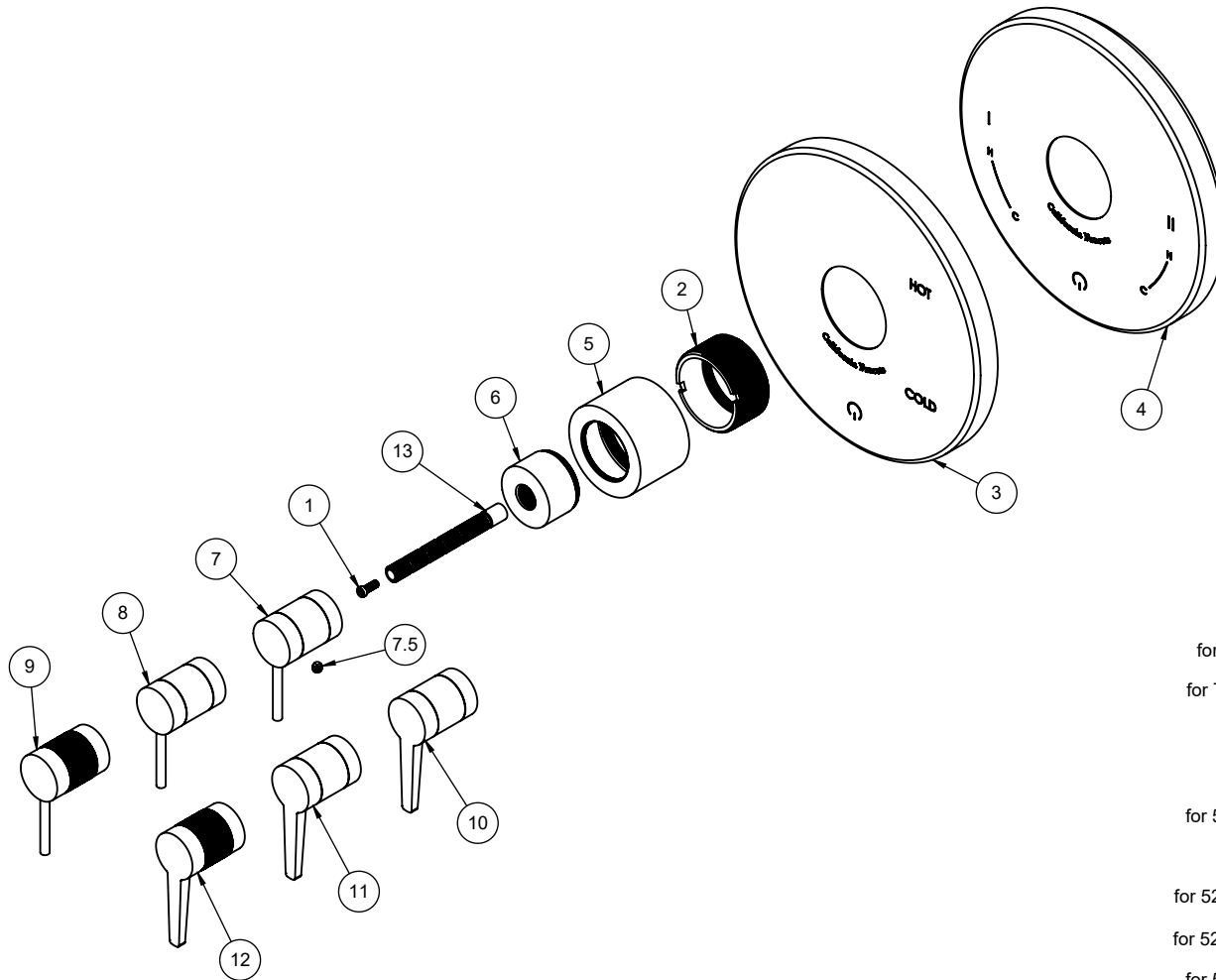

To order spare parts add and/or replace as stated below:

SPD- prefix added to part number(s)
-ZZ replaced with finish code (see finish table)
-WW replaced with **-90** (light finish) or **-96** (dark finish)

Ex: **SPD-7-100463-PC** or **SPD-86030-96**

ITEM	PART NO.	DESCRIPTION	QTY
1	86078-90	SCREW, M4 X 0.7 X 10MM, w/Ø5.80 PHL PH HD SS	1
2	10292-98	BUSHING, PB G2	1
for TO-PBL	3	7-100106-ZZ ASM, CONT PB PLATE & GASKET	1
for TO-PB2L	4	7-100547-ZZ ASM, CONT PB2 PLATE & GASKET	1
5	10294-ZZ	ESCUTCHEON, CONT, PB G2	1
6	571380-ZZ	ESCUTCHEON, 57, SERIES	1
for 52 Series	7	7-100506-ZZ ASM, STICK HDL W/SMOOTH CYL - THERM (incl. 7.5)	1
	7.5	86033-WW SETSCREW 10-24 X 3/16 SCKT HD CUP PT SS	1
for 52F Series	8	7-100507-ZZ ASM, STICK HDL W/C. FIBER CYL - THERM (incl. 7.5)	1
for 52K Series	9	7-100508-ZZ ASM, STICK HDL W/KNURLED CYL - THERM (incl. 7.5)	1
for 53 Series	10	7-100509-ZZ ASM, TANG HDL W/SMOOTH CYL - THERM (incl. 7.5)	1
for 53F Series	11	7-100510-ZZ ASM, TANG HDL W/C. FIBER CYL - THERM (incl. 7.5)	1
for 53K Series	12	7-100511-ZZ ASM, TANG HDL W/KNURLED CYL - THERM (incl. 7.5)	1
13	880137-98	BROACH EXTENSION 3-1/4"(L) X 16T(M) X 20T(F)	1
for ITEM 7.5	14	882043-99 KEY, ALLEN, 3/32", BLACK	1