

8508
8508B
8508W

△ REQUIRES ITEM ②①
△ REQUIRES ITEM ⑩

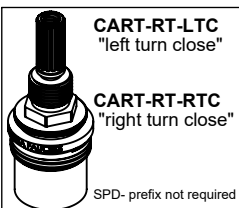
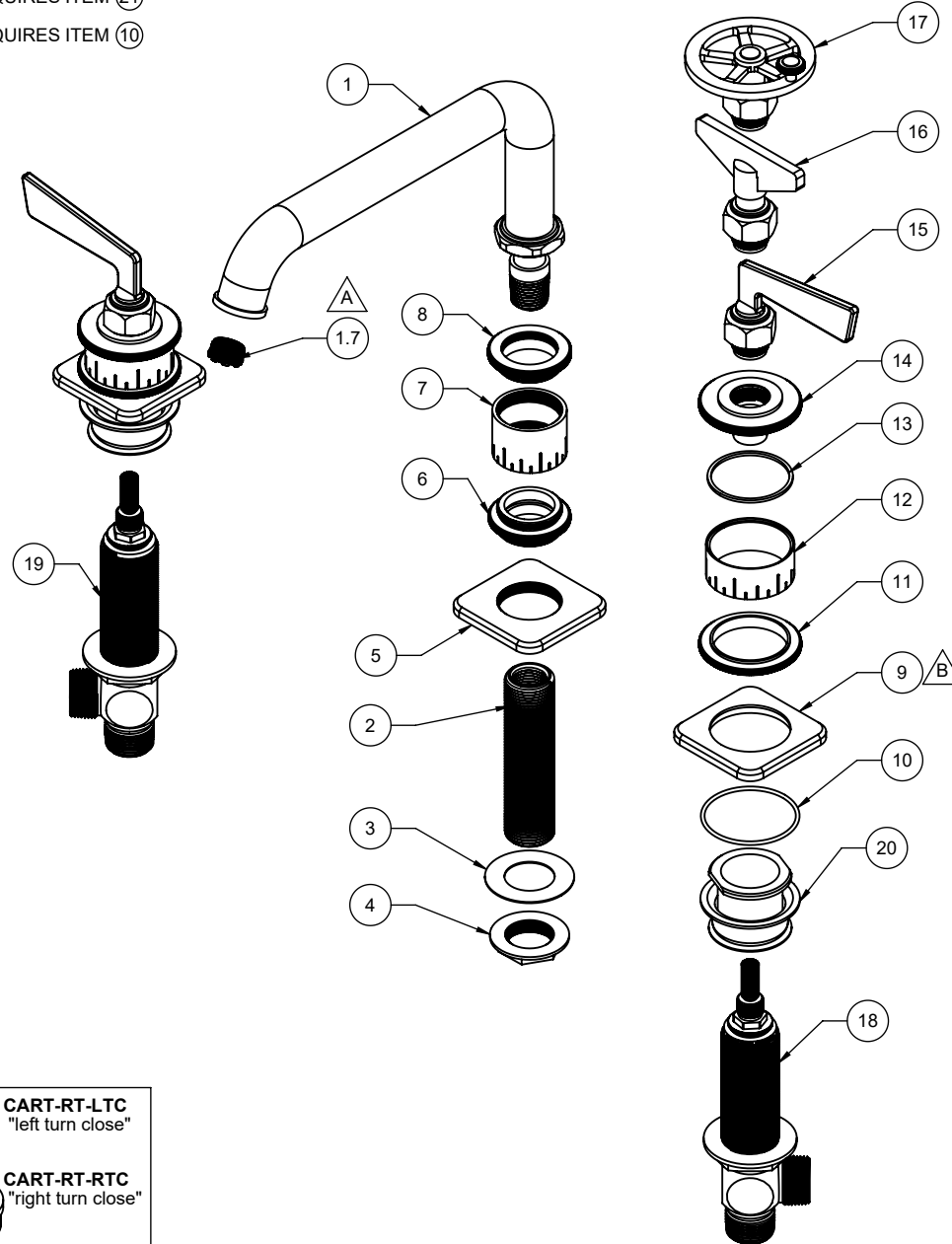

To order spare parts add and/or replace as stated below:

SPD- prefix added to part number(s)
-ZZ replaced with finish code (see finish table)
-WW replaced with **-90** (light finish) or **-96** (dark finish)

Ex: **SPD-7-100463-PC** or **SPD-86030-96**

ITEM	PART NO	DESCRIPTION	QTY.	
1	7-100338-ZZ	ASM, INDUST RT 2 BEND SPOUT (incl. 1.7)	1	
1.7	880453-81	INSERT, TJ AERATED (CACHE), MAX FLOW, LT GRAY/WHT	1	
2	880392-98	NIPPLE, 3/4 NPT/NPSM X 4-1/8" X 3/4" SWEAT	1	
3	881253-99	WSHR 1"-20 SHANK - SS	1	
4	882805-99	FLANGE NUT, 3/4"-14 NPSM X 1.68 OD X .30 HT	1	
5	10814-ZZ	RING, SQ ROUNDED SPOUT BASE	1	
6	10815-ZZ	COIN, SPOUT BASE BOTTOM	1	
7	10816-ZZ	BASE, SPOUT W/ HASH	1	
8	10817-ZZ	COIN, SPOUT BASE TOP	1	
9	10820-ZZ	RING, SQ ROUNDED BASE	2	
10	87263-80	O-RING Ø49.00 X 2.00 (NA) BUNA-N A70	2	
11	10821-ZZ	COIN, ESCUTCHEON BOTTOM	2	
12	10822-ZZ	ESCUTCHEON, HASHED	2	
13	87254-81	WSHR Ø42.16" X Ø45.87 X 1.57MM ACETAL	2	
14	10823-ZZ	COIN, ESCUTCHEON TOP	2	
for 85 Series	15	7-100322-ZZ	ASM, FLAG INDUSTRIAL LEVER	2
for 85B Series	16	7-100324-ZZ	ASM, KEY INDUSTRIAL LEVER	2
for 85W Series	17	7-100323-ZZ	ASM, WHEEL INDUSTRIAL LEVER	2
	18	6-200081	ASM, COLD-RT BODY, CART & NUT (LTC) (incl. CART-RT-LTC)	1
	19	6-200082	ASM, HOT-RT BODY, CART & NUT (RTC) (incl. CART-RT-RTC)	1
	20	6-200297	KIT, RT INV NUT - 2 SETS (1 SET - 6-200297-1)	1
	21	223472-99	KEY, TT CACHE AERATOR INSERT	1